

■ DESCRIPTION

The TS-V90SU is a Signal distributor unit used to connect between the conference system's Master control unit (TS-V90MU) and Conference units (TS-V91CU Chairman unit and TS-V92DU Delegate unit).

■ SPECIFICATIONS

| | |
|--|--|
| Power Source | 36V DC (supplied from the Master control unit TS-V90MU) |
| Current Consumption | Max. 10mA |
| Connection Terminal | Connect to Master control unit: Cable length 2m with 8 pins DIN plug Connect to Conference units: 8 pins DIN Socket x 2 |
| LED Indicator | Power status indicator |
| Number of Connectable Conference units | Max. 27 units |
| Operating Temperature | 0 °C to +40 °C (32 °F to 104 °F) |
| Operating Humidity | 90 %RH or less (no condensation) |
| Finish | Steel plate, black paint, 30% gloss |
| Dimensions | 90 (W) x 37 (H) x 97.5 (D) mm (3.54" x 1.46" x 3.84") |
| Weight | 450 g (1.00 lb) |

■ APPEARANCE

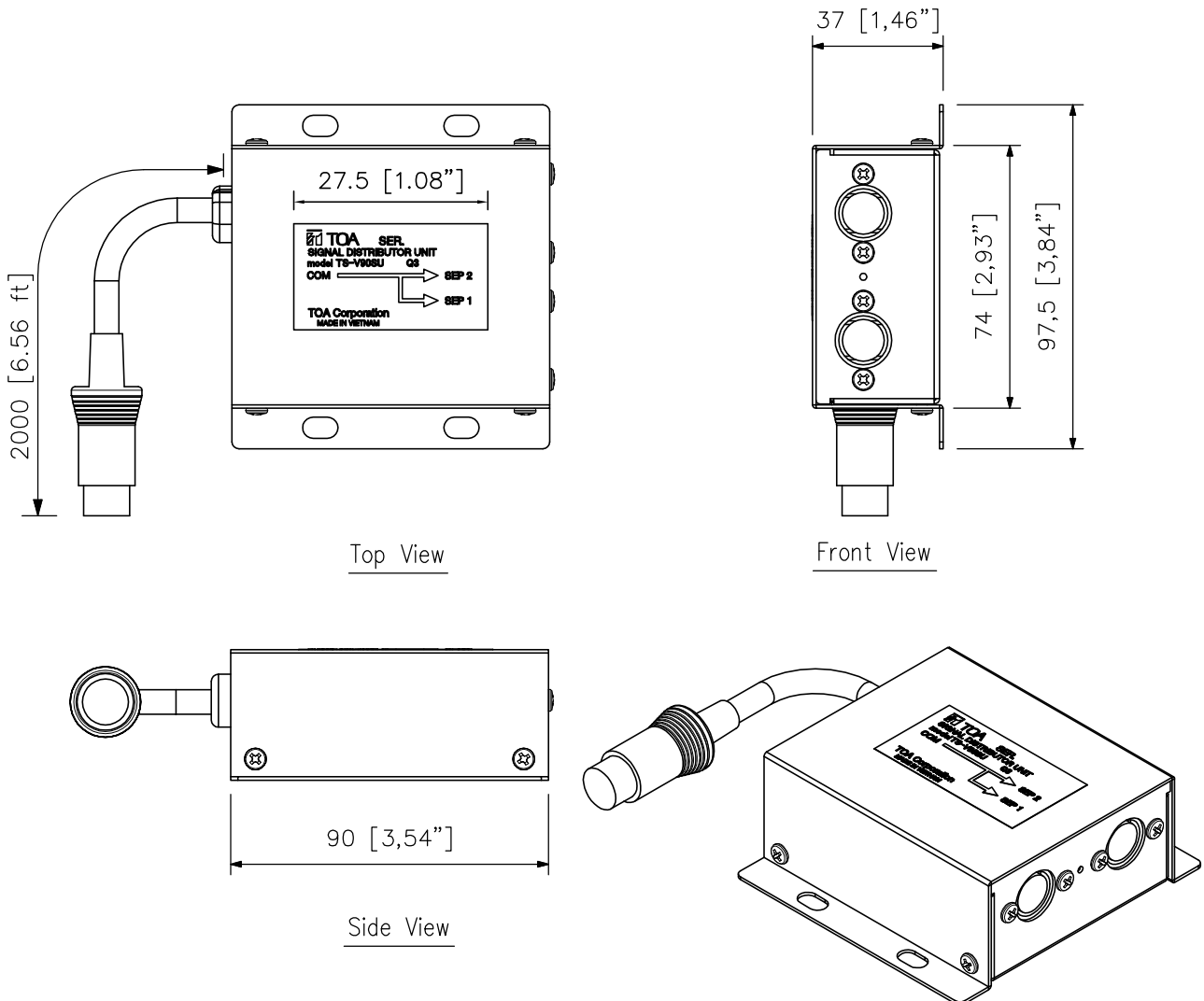

UNIT: mm SCALE: 1/2